BLACK Family Cemetery

Glade District, Oglethorpe County, Georgia

Location: end of Pea Ridge Road, N 34°00'05" W 83°02'40"

Research and narrative by descendants: Mr. Glenn M. Paul and Dr. Michael M. Black

Buried in this cemetery are members of a family prominent in the early history of Oglethorpe County. Descendants of this family are found to this day in Franklin, Madison, Clarke, Wilkes, Oglethorpe, and Jackson counties and throughout the states of Georgia, Alabama, South Carolina, and North Carolina. Thomas Black and his family (including son Lemuel Black) emigrated from Pittsylvania County, Virginia to Wilkes County, Georgia in 1787.¹ They received headright grants in Wilkes County which later became Elbert County then Oglethorpe County.

After many years of searching, this cemetery was located in October 2009. It does not appear in the current edition of the Oglethorpe County Cemetery Book but has been submitted for the next edition.²



M. M. Black, Sept. 18, 2010

Black Family Cemetery

¹ Thomas Black and Lemuel Black appear in the 1787 Wilkes County tax digest in Capt. Clark's District.

² This is one of three Black Cemeteries in the tri-county area; one is located in Madison County and one in Elbert County.

Tracing the Black Land

To confirm that we located the correct cemetery, the Black land was traced from the time it was sold by the Blacks to the current day.

After the death of Mary Ann (Williams) Black, widow, John W. Black, executor of the Lemuel Black Sr. estate, sells the Black land to Stephen H. Stokely for \$950.00 on Oct. 1, 1872.

John W. Black as Administrator as aforesaid have granted bargained and Sold and do by these presents grant, bargain and sell so far as the Office of Administrator authorizes him unto said Stephen H. Stokely the following described Real Estate, to wit: a Tract of Land containing One hundred and forty five Acres more or less, in said County of Oglethorpe adjoining lands of Abel Eberhart Sen^r _J. G. Olive_ W^m-W. Bush + others on the Waters of Little Beaverdam Creek and known as Mary Ann Blacks Dower Tract_ With the exception of one fourth of an Acre which is reserved in and around the family Grave Yard and not Conveyed or intended to be Conveyed by this Deed_ ³

On Oct. 12, 1876, Stephen H. Stokely sells the tract to Thomas R. Tiller.

...that tract or parcel of land situated, lying and being in the county of Oglethorpe and State of Georgia containing one hundred and forty five acres, more or less, and adjoining lands of Jesse G. Olive, Abel Eberhart, B. H. Witcher and others known as the Mary Black Dower.

Thomas R. Tiller deeded the land to James M. Tiller.⁴ In 1912, J. M. Tiller had the land surveyed (see next page).

On Oct. 25, 1937, James M. Tiller, Sr. deeds land in consideration of love and affection to Robert W. Tiller (p. 459-460).

All that tract or parcel of land situated, lying and being in Glade District of the State and County, containing one hundred forty five (145) acres, more or less, bounded on North & East by public road leading from Glade to Watson's Mill; on the South by lands of Will Chandler and on the west by Beaverdam Creek, and known as the Mary Ann Black Dower tract; this is the same land deeded by John W. Black to Stephen H. Stokely which will be found of record in the office of the Clerk of the Superior Court in Deed Book W, on pages 302 & 303; later deeded by S. H. Stokely to T. R. Tiller on October 12, 1876- found of record in the office of the Clerk of the Superior Court in said county in Deed Book CC, on page 233 and the description in all of said deeds is hereby incorporated herein and made a part of that here given.

³ Clerk of Superior Court, Lexington, Oglethorpe Co GA, deed book W (1870-75), p. 302-303

⁴ Clerk of Superior Court, Lexington, Oglethorpe Co GA, deed book CC, p. 233

Surveyed and platted by W. A. Broach, **January 12, 1912**

This plat represents a tract of land belonging to J. M. Tiller being and lying in Glade District adjoining lands of W. H. Chandler on the South, J. S. Chandler on the South and West and bounded on West by Beaverdam Creek, on the North by public road and on East by public road and other lands of J. M. Tiller. Said tract of land known as the Black Place. Containing one hundred and sixty eight and three tenths ($168 \frac{3}{10}$) acres, more or less.

Beginning at rock near cotton house, survey is as follows-

N 87½	W 3.80	N 40	E 1.75	S 53	E 3.81
N 89¾	W 25.70	N 24	E 1.44	S 45	E 4.70
N 18	E .25	N 23	E 2.50	S 50	E 3.38
N 56	W 20.85	N 7	E 7.34	S 30	E 2.45
N 85	W .50	N 61½	W 1.73	S 40	E 11.56
N 32	W 17.50	S 75½	E 6.00	S 45¾	E 2.84
N 39	E 1.88	S 79½	E 11.39	S 10½	E 15.75
N 26½	E 3.77	S 55½	E 11.12		
N 33½	E 1.69	S 59½	E 3.09		

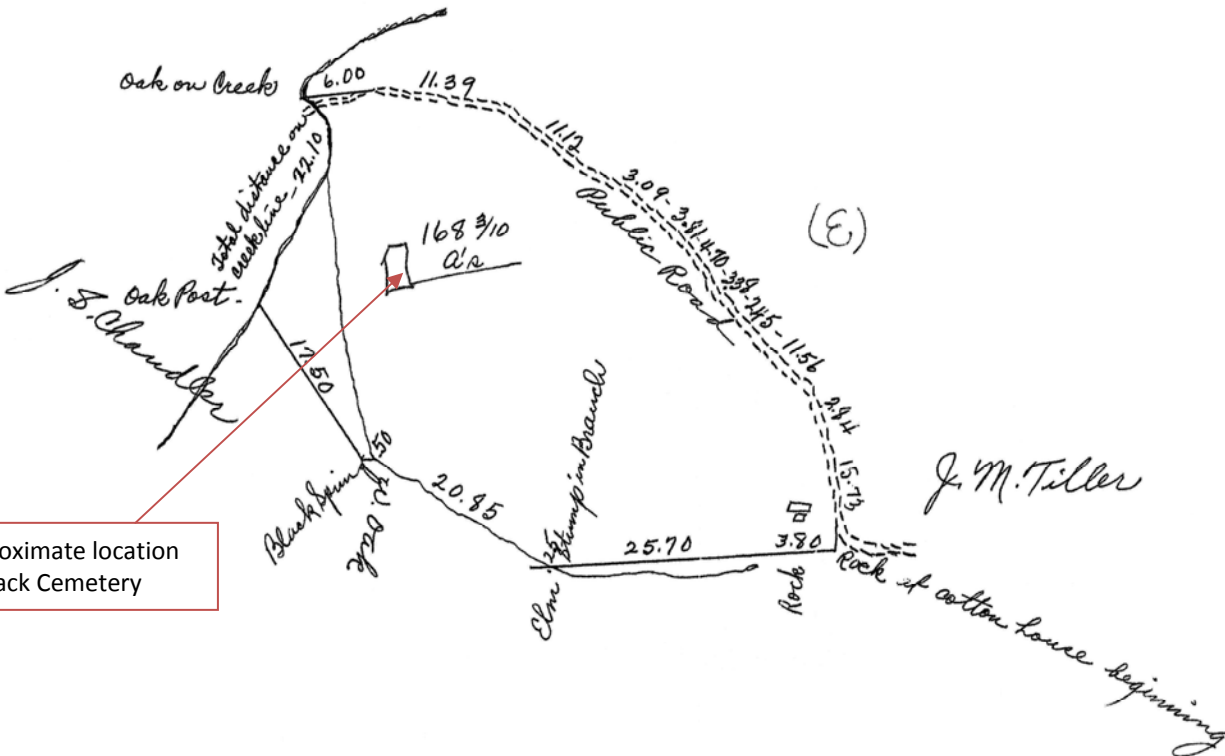

The land was later sold to the Georgia Kraft Company (owner of record in 1967) and then to various timber companies, the last of which was East-West Timberland. In 2010, the current owner Terra Silva LLC of Marietta, GA, purchased the parcel January 14, 2002 from East-West Timberland for \$213,030.

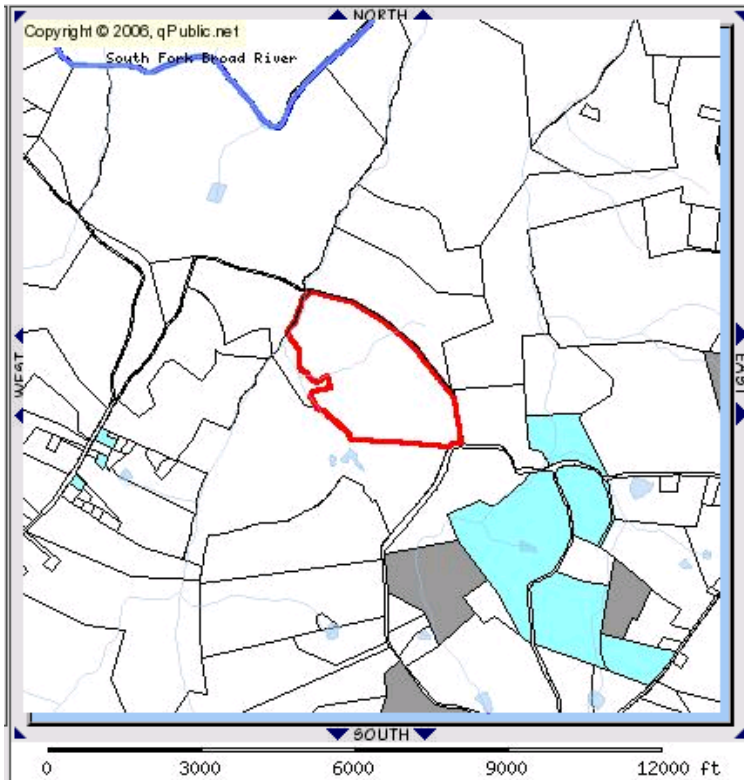

Source:
Oglethorpe County, GA Parcel Maps
Parcel 110 020
Acres 144.64
Rolling topography

Map Location

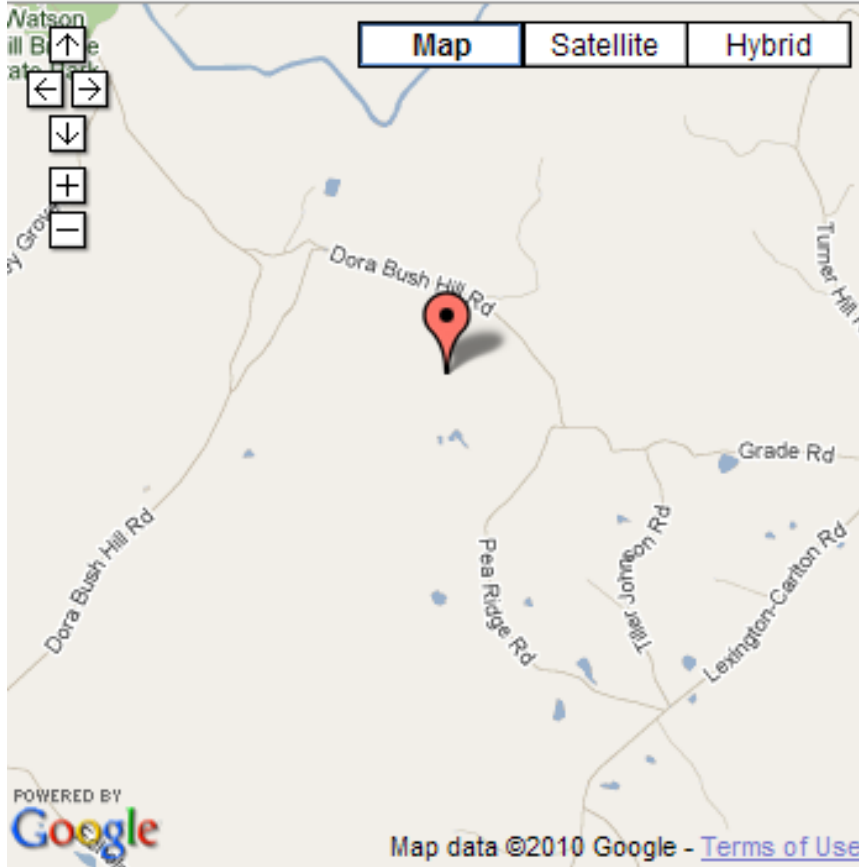

Decimal Degrees

Latitude

34.001389

Longitude

-83.044444

Degrees, Minutes &

Seconds

Latitude

N34 00 05

Longitude

W83 02 40

GPS

Latitude

N 34 00.083

Longitude

W 83 02.667

Directions

Visiting the Black Cemetery is a challenge because of its distant location from a public road. Several years ago, the property owners at the end of Pea Ridge Road petitioned to Oglethorpe County to have their road made into a private road. Because this road is non-county maintained, the owners have locked gates along their property. We recommend you contact the property owner or caretaker to request permission to access the property. The land is used for deer hunting so be cognizant of the season and time of day before visiting. We recommend a visit other than during the season. Hunters use the weeks prior to deer season to prepare feed plots and disturbing the feed plots can impact their hunting season. The following is a simple diagram with directions to the Black Cemetery.

Diagram to Black Cemetery

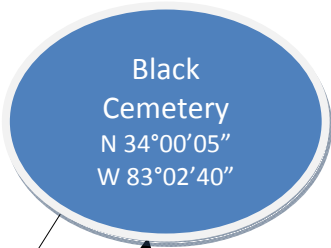

0.24 miles

downhill

take path to right

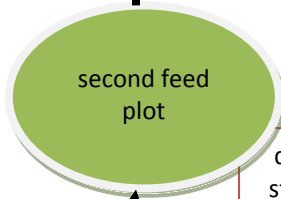

deer stand

downhill

deer stand



mowed field

locked gate arms; use left gate

end of Dora Bush Hill Rd.

end of Pea Ridge Rd.

Cemetery Photographs

from September 18, 2010 by Michael M. Black

Although the gravestones in this cemetery are worn, many fieldstones and a wolf crypt mark this approximate quarter-acre cemetery. Twenty-two (22) graves were counted. The following individuals are believed to be buried here. Deeds, census, and other records serve as sources.

- Black, Lemuel
 - c1759-1825
 - son of Thomas Black and Mary _____
 - married Mary Ann Williams May 25, 1794 in Elbert County, GA
 - A timeline of his life is available online at www.valdosta.edu/~mblack/followinglemuelblack.pdf
- Black, Mary Ann
 - Jan. 18, 1778-1870
 - wife of Lemuel Black
 - daughter of Mathew Jouett Williams and Barbara Walker
- Black, James "Jim" Smith
 - June 27, 1813-aft. 1882
 - son of Lumuel Black and Mary Ann Williams
 - married Nancy Jane Martin Nov. 4, 1832
 - married Letty Jane Eberhart Mar. 11, 1857
- Black, Nancy Jane Martin
 - c1815-c1856
 - married James Smith Black Nov. 4, 1832
 - living Apr. 24, 1853; husband remarried Mar. 11, 1857

Possibly buried here:

- Black, Thomas
 - c1740-1800
 - appears in 1800 Oglethorpe County, GA census; earliest estate record Jan. term 1801; will recorded February 3, 1801
 - known children: Lemuel, John, Thomas James, William, James, Mary "Polly", Agnes
 - A list of his descendants is available online at www.valdosta.edu/~mblack/genealogy.html
 - A timeline of his life is available online at www.valdosta.edu/~mblack/tracingthomasblack.pdf
- Black, Mary
 - c1740-c1812
 - appears in the 1811 Clarke County, GA tax digest
 - wife of Thomas Black
 - maiden surname unproven



inside the above crypt













Glenn Paul and Michael Black stand beside a crypt at the Black Cemetery



Jim Black and Michael Black stand beside a crypt at the Black Cemetery

For information on the Black family, contact:

Dr. Michael M. Black
mblack @ valdosta.edu

OR

Mr. Glenn M. Paul
glennm31 @ windstream.net

This document can be retrieved from
www.valdosta.edu/~mblack/blackcemetery.pdf